

# Cabin Air-chair



## Owner's manual

Read the manual carefully and in case of doubt kindly contact our customer service

Moventuras Oy  
Valimotie 13a  
FIN -003580 Helsinki  
tel +358 40 555 8818  
[contact@moventuras.com](mailto:contact@moventuras.com)



---

## Warranty

Moventuras Oy guarantees a two (2) year warranty for the CABIN AIR's frame and chassis. On every chair there is a model plate which shows a unique serial number.

This warranty covers faults that occur in normal operation of the Cabin Air. The warranty does not cover faults caused by normal wear and improper or lack of maintenance as indicated in the owner's manual and the service instructions.

Furthermore, the warranty does not cover faults originating from overloading. Normal wear occurs in parts such as tires, rubber mountings, joints, and seat cushions.

Indirect expenses incurred in dealing with faults are not included in the warranty.

Only parts supplied/approved by the manufacturer may be used in wheelchairs. If other parts are used, Moventuras Oy is not liable for any damage.

---

# SISÄLTÖ

## Table of contents

1 SAFETY RECOMMENDATIONS .....	5
1.1 Applicability for different type of users.....	5
1.2 Safe Using .....	5
1.3. Maintenance .....	6
1.4 Markings.....	6
2 HOW TO ADJUST THE EQUIPMENTS.....	7
2.1.Adjusting the seat, headrest, side supports and footboard. ....	7
2.1.1 Adjusting headrest .....	7
2.1.3 Adjusting side support .....	7
2.1.4 Adjusting footboard .....	8
2.1.5 Adjusting the length of the bottom carrying handles.....	8
2.1.6 Adjusting the upper carrying handles.....	9
2.2 Other equipment and accessories .....	9
3 USING CABIN AIR- CHAIR .....	10
3.1 Moving to a chair.....	10
4 HOW TO USE BRAKES.....	11
5 MAINTENANCES .....	12
5.1 Cleaning and disinfection .....	12
6. REUSE AND RECYCLING .....	12
7. CHAIR STORAGE .....	13
8. CABIN AIR TECHNICAL DETAILS .....	14

---

# 1 SAFETY RECOMMENDATIONS

Read this manual carefully before using the Cabin Air. It will guide you on flexible and safe use of the chair and advise you on the procedures for problem situations. Please contact the supplier if you have any further questions.

The Cabin Air- chair is mainly intended for indoor use, where it can cross obstacles in normal outdoor conditions and drive on uneven ground. The wheelchair can also be used in suitable outdoor premises.

## 1.1 Applicability for different type of users

The Cabin Air is intended for users weighing not more than 125kg.

The chair is controlled and moved by assistant(s).

## 1.2 Safe Using

Do not use the chair if you suspect that the use would not be safe. For safety, take notice of the chair's condition, function and noises, environmental conditions, and the assistants' ability to control the chair. Check chair's condition weekly at the very least.

Cabin Air chair has moving parts such as wheels, footboard and carrying. Be aware of these hazards when using a chair, especially in the presence of children and domestic animals. Make sure they stay at a safe distance.

The brakes must be locked after using the chair.

Store the Cabin Air chair in dry and warm condition. Do not store the chair direct sun light (metal parts can turn hot) or in frost.

---

## 1.3. Maintenance

Regularly check the condition of the tires. Due to the operational characteristics, it is important that the tires are intact, securely fixed, and not too worn out.

Unauthorized repairs and modifications are prohibited.

Regularly check the condition of the safety belts, the functionality and fastening of the locks as well as the condition of the seat.

Regularly check the fastening of the top and bottom carrying handles, as well as the condition of the locking mechanisms.

Dry the chair after use if it has been used in humid conditions. N.B. Dry the bottom carrying handles when pulled out to avoid moisture build-up.

## 1.4 Markings

Type plate, located on the inside of the rear tyre fork.



---

## 2 HOW TO ADJUST THE EQUIPMENTS

### 2.1. Adjusting the seat, headrest, side supports and footboard.

When adjusting, be careful due to possible risks of flattening. For best adjustment results, use the help of an assistant or service.

#### 2.1.1 Adjusting headrest

The height of the headrest can be adjusted by loosening the clamping screw on the bracket. In case the headrest fastening has loosened, contact service. If the headrest is not used, it can be moved to the bracket under the seat

#### 2.1.3 Adjusting side support

The side supports can be adjusted by turning them up, for example out of the way during the transition of the customer or turning them down to provide support. If the attachment of the lateral supports has loosened, contact a service



---

## 2.1.4 Adjusting footboard

The footboard can be lifted to the top position and folded down again during use. If the footboard attachment has loosened, contact a service.



## 2.1.5 Adjusting the length of the bottom carrying handles

The length of the bottom carrying handles can be increased by 75 mm by pressing the lock button marked in the picture and pulling out the carrying handle at the same time. Lengthening the carrying handles makes it easier to use the chair in situations where assistants have to lift the chair over obstacles, for example. Regularly check the tension of the locking screws on the lower carrier handles. The locking screw is located between the front wheels on the upper surface of the pipe as shown in the picture below.

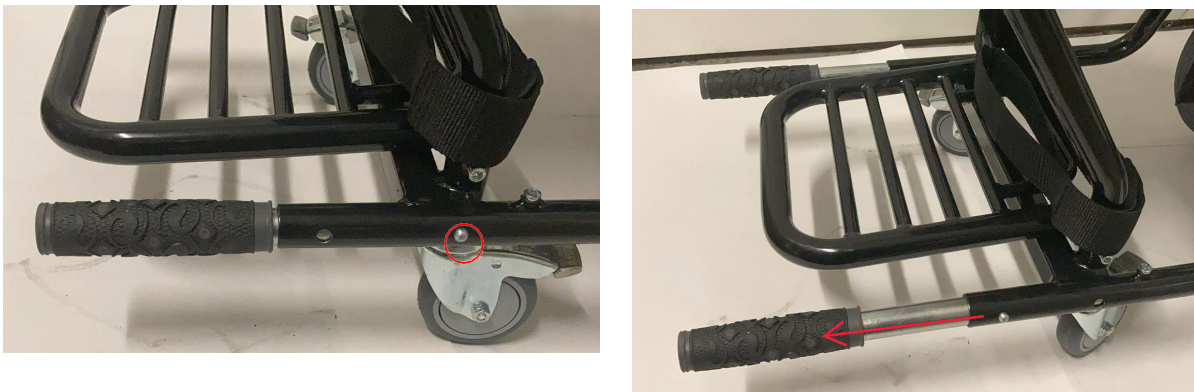

---

## 2.1.6 Adjusting the upper carrying handles

The top carrying handles are adjusted by pulling the locking knobs located behind the backrest and simultaneously lifting the top carrying handle until the handle locks into place

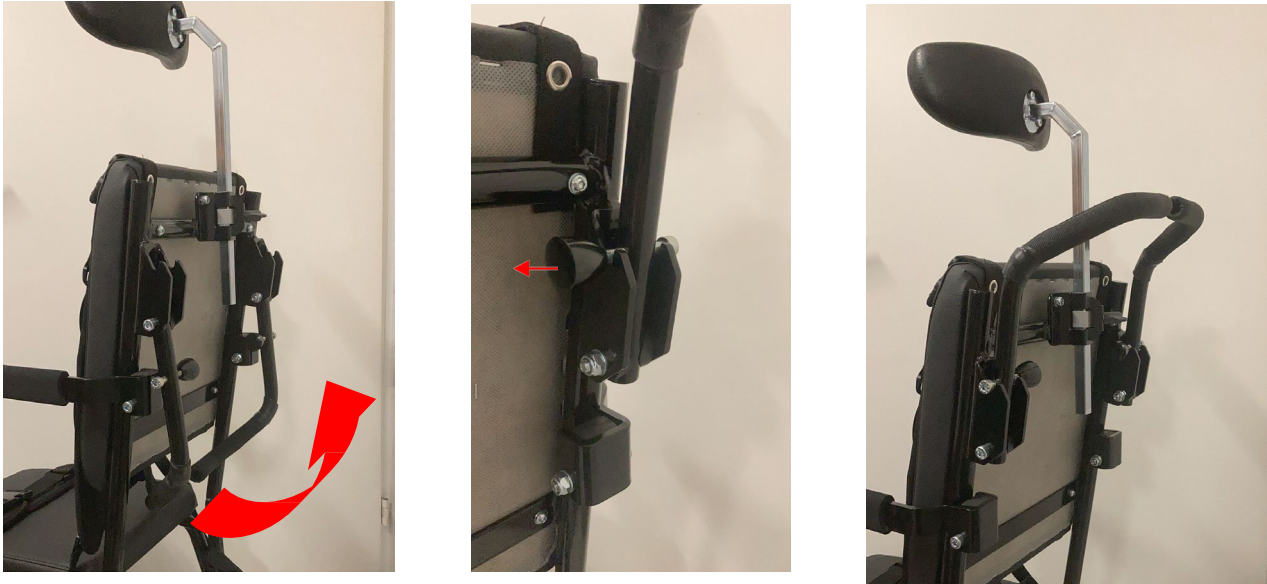

## 2.2 Other equipment and accessories

### 2.2.1 Safety belts

The chair is equipped with a removable seat belt that goes over the thighs and detachable safety harnesses and ankle straps. Their use is recommended. In case the seat belt is not in use, make sure that it does not hang and get stuck in the wheels.





---

## 3 USING CABIN AIR- CHAIR

### 3.1 Moving to a chair

To make it easier to move to the chair, the footboard and side supports can be lifted as shown in the pictures below. IC

#### 1 Lift the footboard up

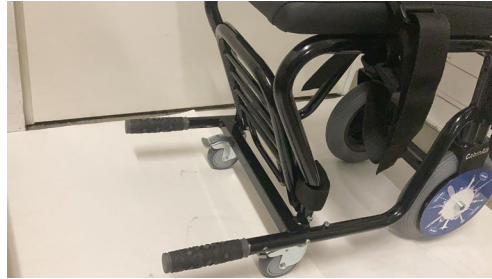

#### 2 Lift the side supports up

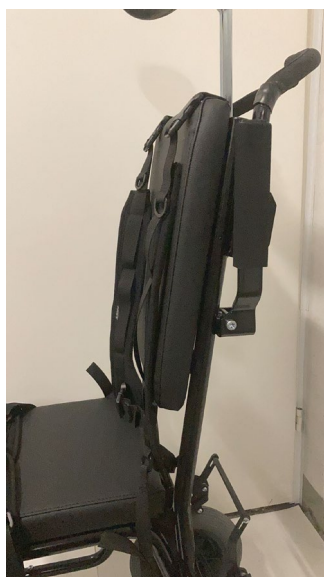
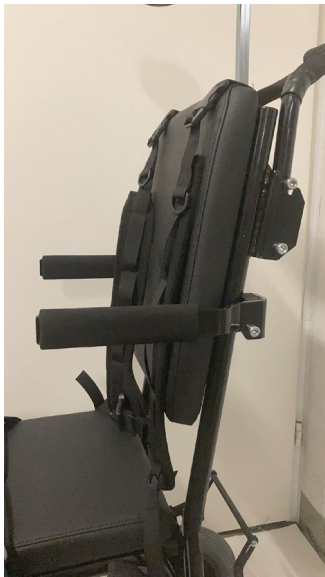

---

## 4 HOW TO USE BRAKES

The brakes are released by turning the brake lock lever located between the rear tires upwards and releasing the brakes on the front tires. Once the brakes are released, the wheelchair can be pushed.

When the chair is not in use, the brakes must be activated by pedaling both the rear brake levers and the front brake levers.

### Front brakes



### Rear brake



---

## 5 MAINTENANCES

After using the chair in humid conditions, make sure, that the chair has dried. Store it in a warm room. Do not leave the chair outside or in a cold/damp area. Failure to comply with these measures may damage the wheelchair. By maintaining your chair regularly, you can ensure that it is reliable and safe. A well-maintained chair is a long-term helper.

The chair must undergo annual maintenance. The manufacturer is not responsible for defects caused by neglected or incorrect maintenance.

Before use, visually check the general condition of the chair. Check that all belts, seat, and cushion are intact and clean. Brake testing is done on a flat floor, put on the brakes and check that the tires do not rotate.

In case of problems, do not use a wheelchair, but contact service.

### 5.1 Cleaning and disinfection

Cleaning of the wheelchair is carried out with a soft cloth dampened in dilute washing liquid. Avoid using undiluted detergents as they may damage plastic and fabric parts. Follow the recommendations of detergent manufacturers for different materials. It is forbidden to use a pressure washer or spray water.

The chair can be disinfected by spraying disinfectant on top of the chair. Disinfection should take into account the leatherette surfaces of the chair, which must be disinfected.

## 6. REUSE AND RECYCLING

The chair is suitable and intended for reuse. For reuse, the chair is subjected to complete maintenance.

All parts of the chair that are removable or replaceable must be recycled appropriately.

---

## **7. CHAIR STORAGE**

Protect the wheelchair from heat and moisture during storage. The chair takes up less space by folding the footrest and handles.

---

## 8. CABIN AIR TECHNICAL DETAILS

Maximum user weight	125 kg
Weight	20 kg
Chair width max (from right to left lateral support)	390 mm
Chair length min (upper handles down/ lower handles short)	730 mm
Chair length max (upper handles up/lower handles extended)	960 mm
Chair height MIN to the top of backrest (without headrest)	950 mm
Chair height MAX (upper handles up, without headrest)	990 mm
Seat:	
- width	330 mm
- depth	400 mm
- height	500 mm
Front wheel diameter	75 mm
Rear wheel diameter	240 mm
Brakes:	
rear wheel	2 pcs combined with a lever
front wheel	2 pcs with levers
Frame	steel frame, powder coating

